



35 Hainault Street, London, SE9 2EF

£1,900 PCM

- 2 Bedrooms
- Garden
- Popular Location
- End Of Terrace House
- Conservatory
- EPC Rating C

35 Hainault Street, London SE9 2EF

Located in the heart of New Eltham village and available September 2025 is this two bedroom end of terrace house. Hainault Street is a popular mews and the property is offered in good order throughout including a modern kitchen, neutral decor and flooring, conservatory and a garden. Very popular location.



Council Tax Band: D



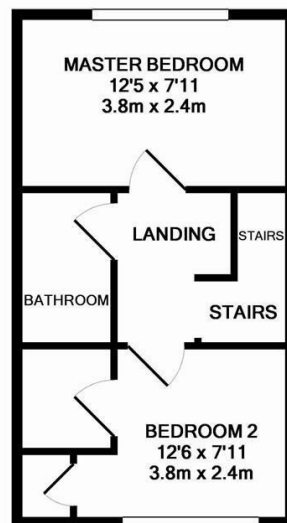
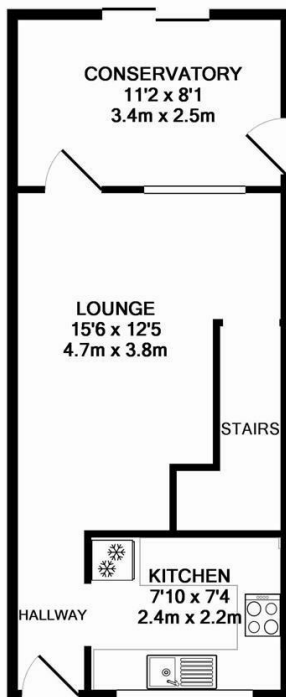

Whilst every attempt has been made to ensure the accuracy of the floor plan contained here, measurements of doors, windows, rooms and any other items are approximate and no responsibility is taken for any error, omission, or mis-statement. This plan is for illustrative purposes only and should be used as such by any prospective purchaser. The services, systems and appliances shown have not been tested and no guarantee as to their operability or efficiency can be given
Made with Metropix ©2016

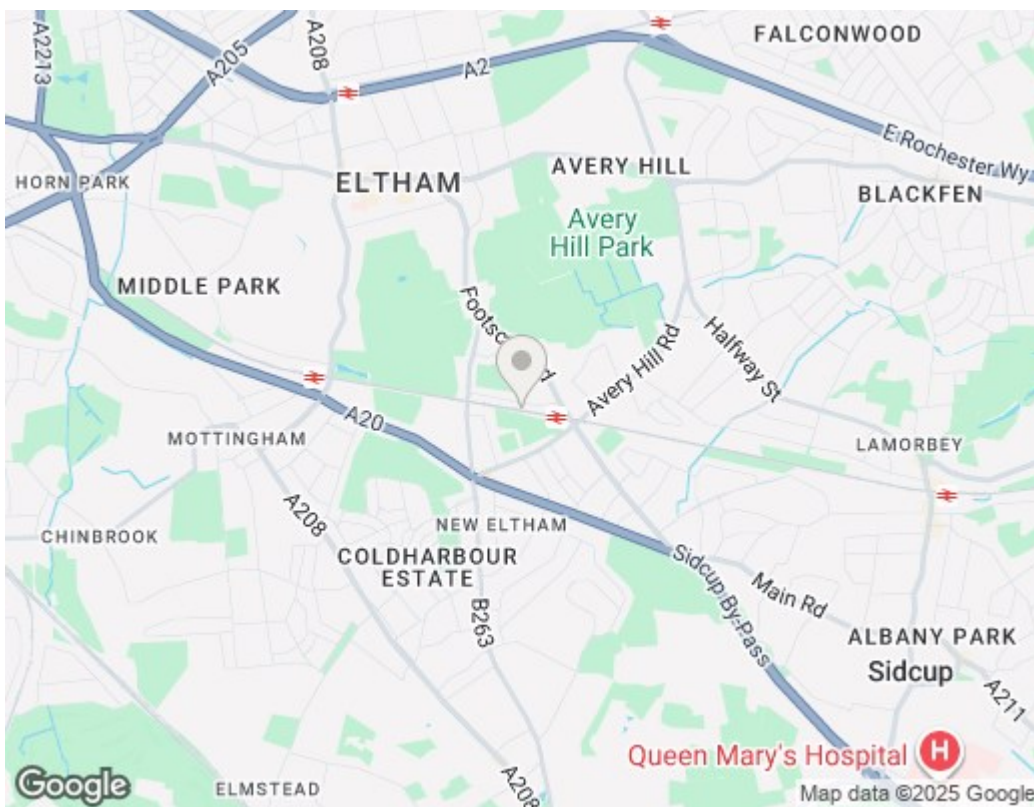

Viewings

Viewings by arrangement only.
Call 0208 859 1100 to make an appointment.

EPC Rating:

C

Energy Efficiency Rating		
	Current	Potential
Very energy efficient - lower running costs		
(92 plus) A		
(81-91) B		87
(69-80) C	69	
(55-68) D		
(39-54) E		
(21-38) F		
(1-20) G		
Not energy efficient - higher running costs		
England & Wales		EU Directive 2002/91/EC